



DeviceNet Slave
Communications Module
 HE800DNS600 & HE800DNS600
 DeviceNet Slave Module



This product has a detailed supplement available (MAN0577).

1 SPECIFICATIONS

	DNS600		DNS600
Communication ports	5-pin screw terminal.	Nodes Supported	-
Status LEDs	Ready Run Error Status	Supported DeviceNet Features	Poll, cyclic, change-of-state, explicit via class 2 Fragmented messages
Configuration	Via RS232 serial port or through Cbreeze / CsCape.	Baud Rate	Max 500 kBaud.
Network	2 Wire RS485	Input	Max 256 bytes
		Output	Max 256 bytes
General Specifications			
Required Power (Steady State)	1.5W (300mA @ 5VDC)	CE	http://www.heapg.com/Pages/TechSupport/ProductCert.html
Required Power (Inrush)	Negligible	UL	
Relative Humidity	5 to 95% Non-condensing	Terminal Type	D-Type, Screw terminal
Operating Temperature	0° to 55° Celsius	Weight	1.9 g (9.5 oz.)

2 CONNECTOR / REGISTERS

DeviceNet Connector Pin Out			
Pin no	Signal		
1	VIn		
2	RXD/TXD-P		
3	Shield		
4	RXD/TXD-N		
5	DGND		

Figure 1 – DeviceNet Connector

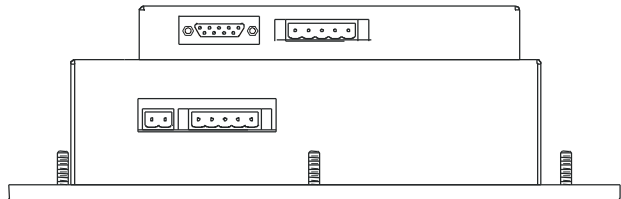

Figure 2 – DeviceNet slave on an OCS

The Fieldbus data registers are mapped through a dual-port ram to the DeviceNet master. The Input and Output data must be mapped as contiguous blocks in the OCS, see the manual.

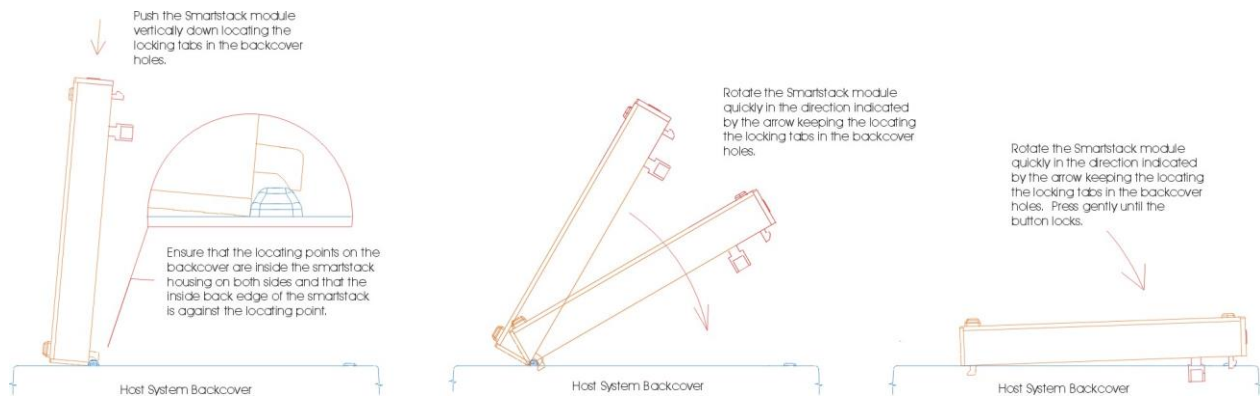

Figure 2.1. How to mount a plastic Smartstack module.

3 INSTALLATION / SAFETY

Warning: Remove power from the OCS / TIU controller and any peripheral equipment connected to this local system before adding or replacing this or any module.

WARNING: To avoid the risk of electric shock or burns, always connect the safety (or earth) ground before making any other connections.

WARNING: To reduce the risk of fire, electrical shock, or physical injury it is strongly recommended to fuse the voltage measurement inputs. Be sure to locate fuses as close to the source as possible.

WARNING: Replace fuse with the same type and rating to provide protection against risk of fire and shock hazards.

WARNING: In the event of repeated failure, do not replace the fuse again as a repeated failure indicates a defective condition that will not clear by replacing the fuse.

WARNING: Only qualified electrical personnel familiar with the construction and operation of this equipment and the hazards involved should install, adjust, operate, or service this equipment. Read and understand this manual and other applicable manuals in their entirety before proceeding. Failure to observe this precaution could result in severe bodily injury or loss of life.

- ◆ All applicable codes and standards must be followed in the installation of this product.
- ◆ Adhere to the following safety precautions whenever any type of connection is made to the module:
 - Connect the safety (earth) ground on the power connector first before making any other connections.
 - When connecting to electric circuits or pulse-initiating equipment, open their related breakers.
 - Do not make connections to live power lines.
 - Make connections to the module first; then connect to the circuit to be monitored.
 - Route power wires in a safe manner in accordance with good practice and local codes.
 - Wear proper personal protective equipment including safety glasses and insulated gloves when making connections to power circuits.
 - Ensure hands, shoes, and floor are dry before making any connection to a power line.
 - Make sure the unit is turned OFF before making connection to terminals.
 - Make sure all circuits are de-energized before making connections.
 - Before each use, inspect all cables for breaks or cracks in the insulation. Replace immediately if defective.
- Use Copper Conductors in Field Wiring Only, 60/75° C

4 TECHNICAL SUPPORT

For assistance, contact Technical Support at the following locations:

EUROPE
 Email: tech.support@hornerirl.ie,
 Fax: +353 (0)21 4321 826
 Tel : +353 (0)21 4321 266
 Website : www.horner-apg.com

USA
 Email: techsppt@heapg.com,
 Fax: +1 317 916 4274
 Tel: +1 317 916 4297
 Website : www.heapg.com